



5/11-15 Eddystone Road, BEXLEY

Space & Tranquillity

Positioned in a tranquil setting at the quiet rear of this exceptionally well maintained "Kawana Gardens" complex, is this renovated & beautifully presented villa. Of particular benefit is the entertainers deck that flows to large "L" shaped courtyard, perfect for alfresco dining, entertaining or relaxing. Being one of the largest villas in the complex with 176m on title and generous proportions throughout, it also features:

- An updated gourmet kitchen incorporating stainless steel appliances
- Plenty of bench & cupboard space
- Bright and airy lounge & separate dining rooms
- Polished light timber floorboards featured throughout
- Updated & immaculate bathroom with separate bath & shower
- Separate toilet and spacious laundry
- Air conditioning
- Lock-up garage with internal access & storage shed
- Security shutters on the bedroom windows

For open space and park lovers, Bexley Park and Bardwell Valley Parklands are only 100m & 300m away. With Bexley shops being only 500m away.

PRICE GUIDE: \$792,000.00

Area: 176 m2
 Council Rates: \$363.00 p.q.
 Water Rates: \$178.00 p.q.
 Strata Levy: \$2,542.00 p.q.



Walter Glaser
 0402443777

argyproperty

OFFICE

02 9588 4888

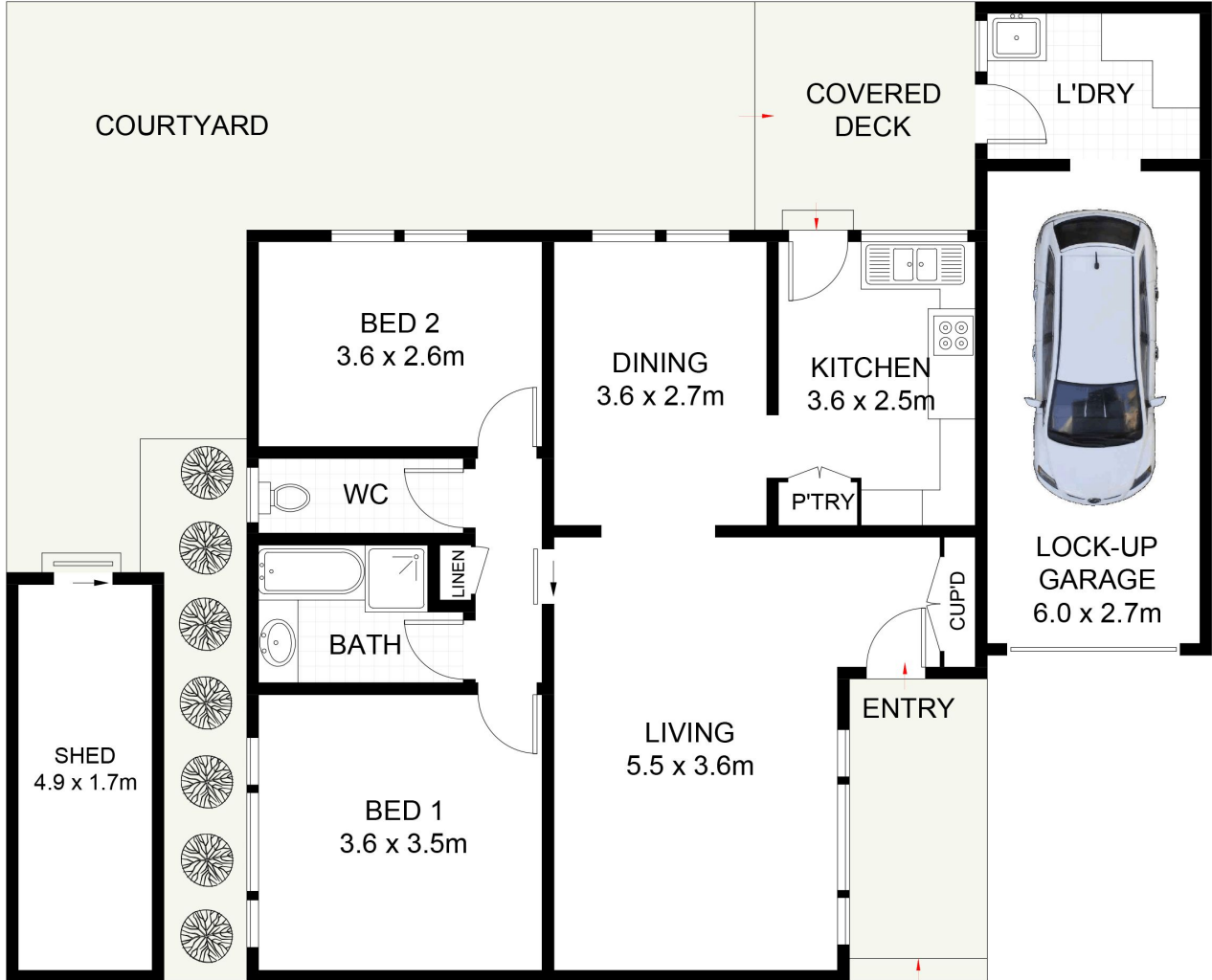

5/11 Eddystone Road, Bexley

Scale in metres. Indicative only. Dimensions are approximate. All information contained herein is gathered from sources we believe to be reliable. However, we cannot guarantee its accuracy and interested persons should rely on their own enquiries.